

Your name \_\_\_\_\_  
Your group members \_\_\_\_\_  
\_\_\_\_\_  
\_\_\_\_\_

## Room 403 Group Mapping:

This assignment is designed to have you work WITH partners to become familiar with the room.

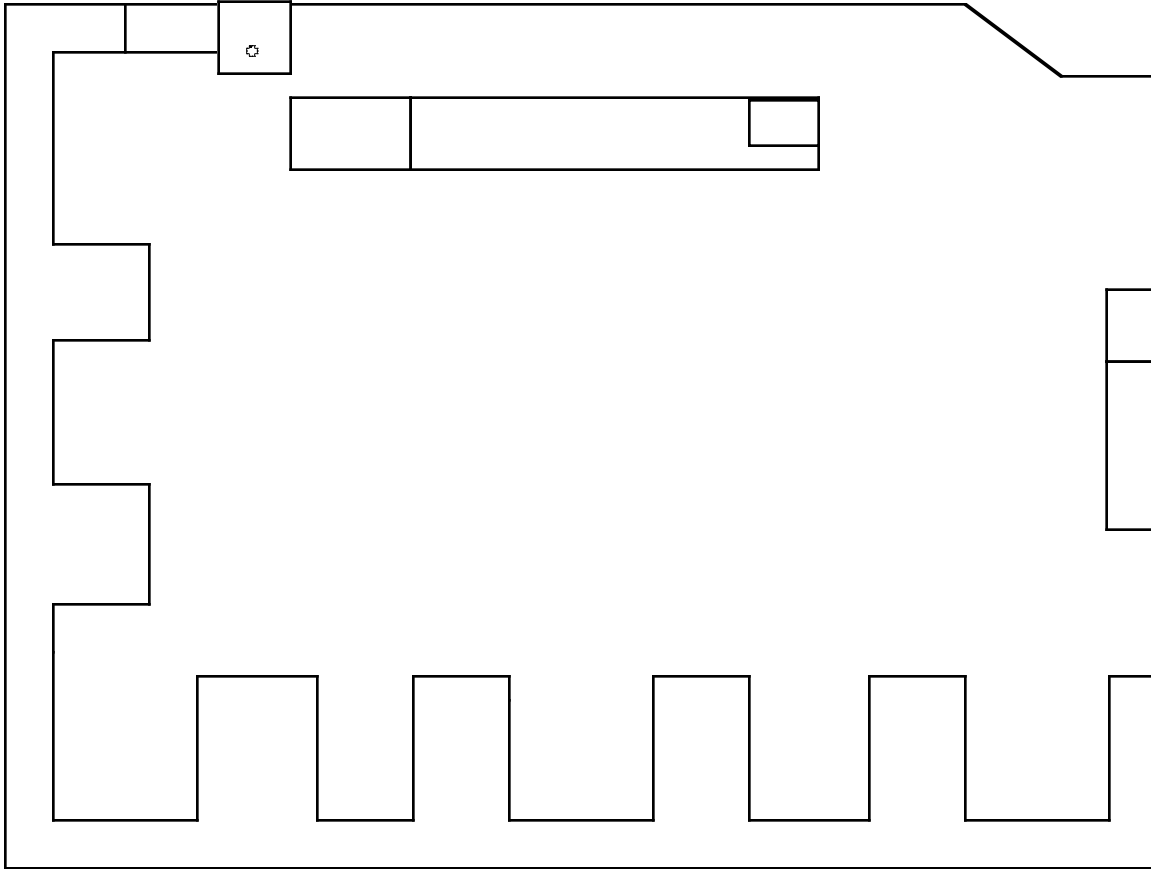

Place each letter in the appropriate place(s) on the classroom map. Be careful! Some letters have more than one location.

- |  |  |
|--|--|
| a. Pencil sharpeners                                 | q. Gas and water shut off valves                           |
| b. Garbage cans                                      | r. Tape (scotch, masking)                                  |
| c. Staplers  | s. MSDS folder   |
| d. Appointment calendar                              | t. Recycling containers                                    |
| e. Emergency exits (e1, e2, e3 in order of use)      | u. Fire extinguisher                                       |
| f. Emergency power shut off (Do <u>not</u> push it!) | v. Class set of textbooks                                  |
| g. Eye wash  | w. Student computers                                       |
| h. Fume hood (Hint: it's large and white.)           | x. Lab stools  |
| i. 3 hole punch                                      | y. Student grades  |
| j. Assignment "In Box"                               | z. Rulers, colored pencils, markers, glue sticks, scissors |
| k. Assignment "Out Box"                              | aa. Community service and extra credit calendars           |
| l. No name box                                       | bb. Extra pens cup   |
| m. Emergency shower                                  | cc. Assignment calendar/agenda                             |
| n. Broken glass container                            | dd. Class worksheets                                       |
| o. Telephone   | ee. Microscopes  |
| p. Exhaust fan timer switch                          |  |

The total # of frogs in the room \_\_\_\_\_.

When your group completes the front, see Miss Kirk for instructions to complete the back.